

C.V.R. Mastic applied at a rate of 3 to 4 Gals. per 100 sq. ft.

POOL FINISH BY OTHERS.
CHECK WITH LAURENCO
TECHNICAL DEPARTMENT
FOR COMPATIBILITY.

POOL AREA

Place 1" vertical & 1" horizontal - 1/8"x4" Butyl Sealant
Tape into interior corner.

POLYSTYRENE BEAD
BOARD 1"x2'x4', adhered
in adhesive.

2 PLIES WATERPROOFING
SHEET WITH ADHESIVE
SEE V-1 SPEC.

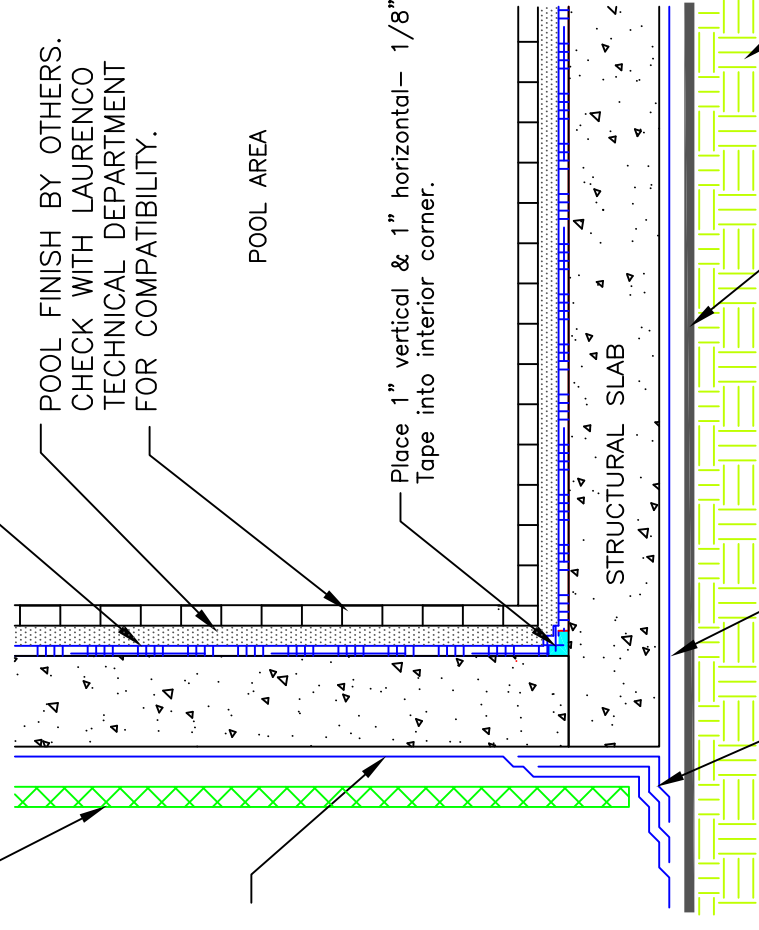

COMPACTED FILL - 98%
MINIMUM

LAURENCO PROTECTION COURSE
See detail 2-A for pattern.

2 plies LAURENCO WATERPROOFING SHEET
with Adhesive. Do not top coat (with adhesive)
the second ply of waterproofing sheet.

2 plies 9" wide waterproofing sheet
in adhesive. Fold waterproofing sheet
4" and 5", place 1st. ply 5" up
and 4" out, reverse on 2nd. ply.