

NOTE: Wale can be in different angles but the same practice is used.

2 plies of Laurenco Sheet & Adhesive to reinforce the transitions.

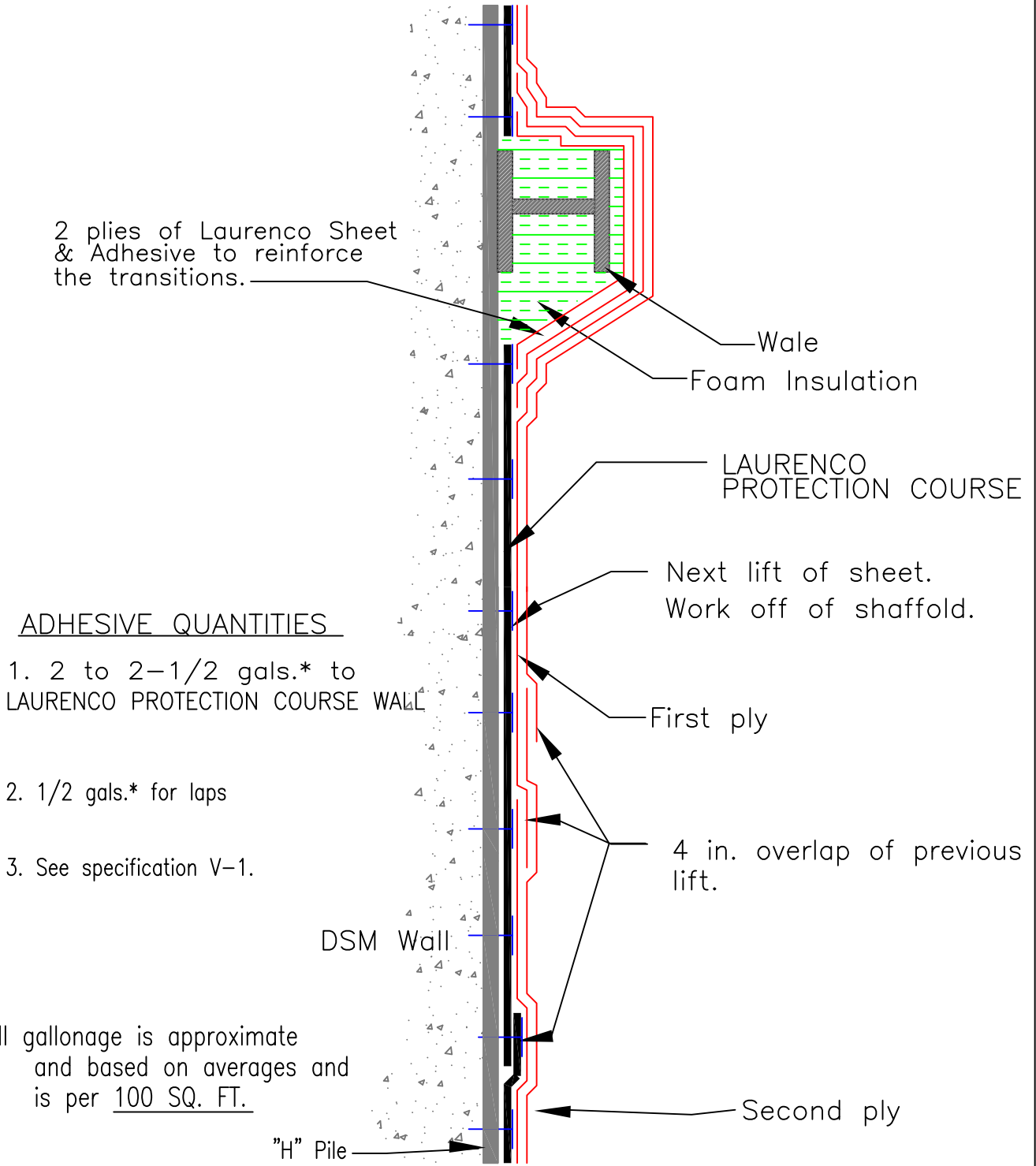

ADHESIVE QUANTITIES

1. 2 to 2-1/2 gals.\* to LAURENCO PROTECTION COURSE WALL
2. 1/2 gals.\* for laps
3. See specification V-1.

\* All gallonage is approximate and based on averages and is per 100 SQ. FT.